

eLIFE

AOR

POWER ASSISTED BICYCLES

OWNERS MANUAL



Firstly may we congratulate you on purchasing your new electric power assisted e.bike.

Please take time to read your manual. We have tried to write it in a way that is simple and easy to follow, whilst explaining how your bike works and how it is maintained.

At any point if you feel you need help we have a technical helpline for support.

Please call our
Technical help line:
(weekdays 9am-5pm)

01702208187

(standard call rate charge applies)

Welcome to the World of e.bike cycling.

Simply explained this is how your e.life bike basically works.

1. Switch the battery to ON, with the switch on the side left-hand side of the frame, to the front of the bike. (Fig.18)
2. Switch the power on by pressing the top left button on your controller on the handlebars. (Fig.15)
2. As you begin to pedal a sensor will read the level of effort needed to turn the wheels of your bike.
3. After one complete turn of the pedal the electric motor kicks in making pedaling much easier.
4. There are 9 settings on your controller on the handlebar, allowing you to set the level of assistance you require. (Fig.15)
For example: Riding up a hill you'll probably use 'High' mode.
5. Change the level of assistance you need at any time and as often as you wish.
6. The motor works to assist pedalling, stop pedalling and the motor stops too.
7. Applying the brakes cuts the motor (Fig.14)
8. You can also choose to switch the assist OFF and ON on the controller at any point in your journey. This helps to save battery power when it's not needed.

The more you use the assist, the more power it uses, each rider is different so figures can vary considerably with different rider weight and the terrain you ride. Generally with normal use, you should be able to obtain around 20 miles, before you need to re-charge your battery.

We Recommend that you get used to your new e.life bike and the level of assist you place on it, you'll soon be able to work out how long a journey you can make and safely return under assist. You can of course ride as you would a normal bike if the charge runs out.

INDEX



Contents check list

1. Your E.Life
2. Saddle & Seatpost
2. Box containing:
 - a. Battery Charger
 - b. Battery Lead
3. Box containing:
 - a. Tool kit and bag
 - b. This Manual
4. Set of Keys
(attached to handlebar cables)

There are video tutorials online or on Ideal World' website designed to assist you if you need help.

IMPORTANT!

PLEASE REMEMBER THAT IT IS IMPORTANT TO KEEP THE CARTON YOUR BIKE ARRIVED IN , COURIERS CANNOT COLLECT YOUR BIKE WITHOUT A CARTON SHOULD YOU HAVE NEED TO RETURN IT TO US.

Page 2	Welcome to E.Life
Page 3	Index & Check List
Page 4	Unpacking your new E.Life
Page 4-6	Unfolding your E.Life
Page 6	Fitting the saddle
Page 7	Pre-Ride checks
Page 7	Getting Started
Page 8	Understanding your controller
Page 9	Understanding your Battery
Page 10	Charging your Battery
Page 11	Maintenance of your E.Life
Page 12	Simple Troubleshooting
Page 13	Warranty
Page 14	Replacement Batteries & Chargers
Page 15	National Service Centre

Please call our
Technical help line:
(weekdays 9am-5pm)

01702208187

(standard call rate charge applies)

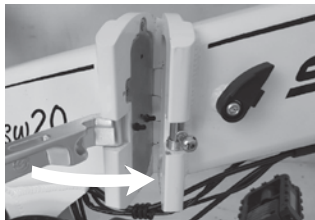

Fig.1



Fig.2



Fig.3



Fig.4

Unpacking your new e.bike

Your bike comes 100% assembled in the Carton

1. Before you begin to unpack your e.bike we recommend you get another person to assist you as it s much easier with **2 persons to lift out of the box.**
2. Remove all the packing materials used to protect the bike and dispose of it later in a responsible manner.
3. Once you have unpacked the bike it is a good idea to check to make sure there has not been any damage in transit. (If you find anything missing or damaged, contact Ideal World customer services)
[idealworld.tv > gb/self-service](http://idealworld.tv/gb/self-service)

Unfolding your e.bike

Step 1. Frame

1. Unfold the frame until the 2 sections are inline (Fig.1)
2. Push the large lever towards the fame to lock together (Fig.2)
3. Turn the Black security clip clockwise until covers the pin on the Lever, this prevents the Lever from opening. (Fig.3)
4. To fold your frame for transport of storage simply reverse steps 1-3.

PLEASE NOTE:

When you have unfolded your frame its a good idea to rest your bike on the bike stand which is attached to the left rear chainstay, this makes it much easier to complete the other steps. (Fig.4)

Unfolding your e.Life



Step 2. Handlebars and Stem

1. Unfold by lifting the handlebars and Stem until it is sitting vertically. (Fig.5)
2. Raise the clamp arm up towards the stem to lock inplace. (can be a little stiff, so please push hard) (Fig.6)
3. Rotate the security ring until the arm of the security ring slides into the slot on the clamp arm. (Fig.7)
4. Should you need to align the front wheel with the handlebars untighten the central allen key bolt - align - and re-tighten. (Fig.5)
5. To adjust the height of the handlebars simply release the quick release by lifting the arm outwards as shown, if extra tightness is required turn the knurled nut clockwise till required tightness is obtained. (Fig.8)



Fig.5

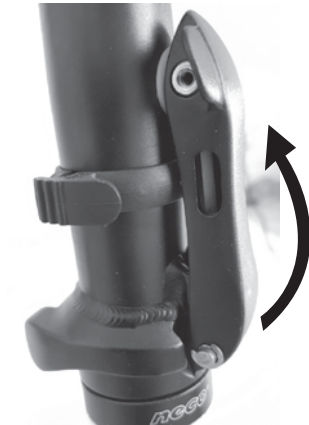

Fig.6



Fig.7

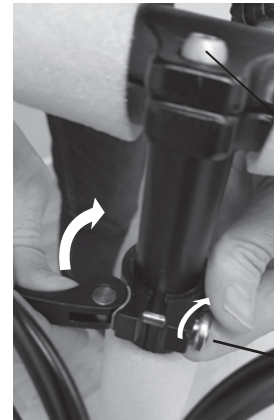

Fig.8

There are video tutorials online or on Ideal World's website designed to assist you if you need help.

Handlebar position can be adjusted by simply slackening of the 2 allen key bolts, retighten evenly.

Knurled adjustment nut a quarter of a turn until required tightness is obtained.

Unfolding your e.bike

Step 3. Pedals

- 1.To install the pedal, the right hand pedal should screw in **CLOCKWISE** and the left-hand screw in **ANTI-CLOCKWISE**.(Fig 9)



Fig.9



Fig.11

Knurled adjustment nut a quarter of a turn until required tightness is obtained.



Fig.12

Fitting the Saddle

The Saddle and Seatpost are already fitted together.

2. Slide the seatpost into the seatbube and close the tension lever on the quick release clamp to lock your seat in place. (Fig.11)
3. Adjust the saddle height to suit you by releasing the clamp and tightening when at the correct height.
4. If the clamp does not tight enough to hold the saddle in position simply release the tension lever and turn a quarter of a turn on the wheel nut and close the tension lever. Repeat as necessary.

NOTE: Should you ever need to replace the pedals remember the right pedal tightens clockwise and the **left pedal anti-clockwise**.

- 2.To fold the pedals for storage or transportation, pull the pedal outwards and fold downwards. (Fig10)



Fig.10

(Fig.12)

NOTE: Be sure not raise the seatpost higher than the minimum insertion mark clearly on the seatpost.

Pre-Ride Checks

Complete these checks before every ride

1. Check to make sure all nuts/fastenings are tight
2. Check that your tyres are inflated sufficiently (see tyre wall)
3. Check that the brakes are working correctly. (These are set by the factory and should not require adjusting).
4. **Check your battery for charge.**
(Note: Your new e.life battery is supplied with a partial charge)

Getting Started

1. Switch the battery on with the switch on the front left-hand side of the frame. (Fig.18)
2. Press top button on the Controller on your handlebars (Fig.15)
3. 'MODE' is set on '1' - This is a default setting.
THAT'S IT.....You're ready to go.
4. To start , simply begin to pedal. Once the crank is turning you will feel the motor kick-in and the electric system begin to assist you.
5. You have 9 levels of assist and its a good idea to try all levels to give you a feel of the effect this has on your riding. (Fig.15)
6. Remember, stopping pedalling or braking cuts the motor assist, so you can always feel safely in total control.



Fig.13

The Battery charge level is shown on the Control module on your handlebar.



Fig.14

Applying the brakes activates the brake sensor which cuts the power to the motor.

Understanding your controller

Your Module Controller has many functions and is relatively simple to use, to the left is listed the the buttons and their various functions.



Press to switch ON/OFF

Light click press activates these functions:

- ◆ Battery Voltage
- ◆ Speed (Real-time speed, Average speed and Max speed)
- ◆ Trip distance and Total distance
- ◆ PAS Level
- ◆ Headlight Status
- ◆ Error Code
- ◆ Various parameters settings, such as wheel size, speed-limit, backlight brightness and so on.

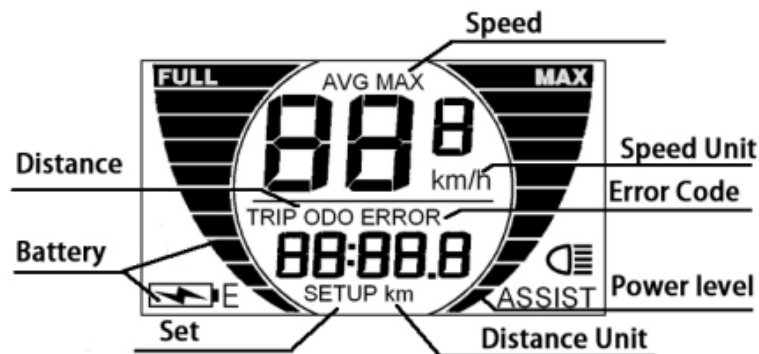

Press to increase assist level 1-5.



Press to reduce assist level 5-1.

Fig.15

Holding down this button activates the 'WALK MODE' which engages the motor from a standing start up to 6KM which is a great way to set of from traffic lights, or when walking with your bike.

Understanding your battery

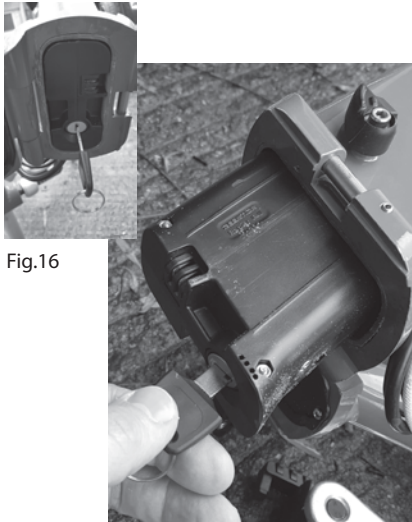

Fig.16

Fig.17

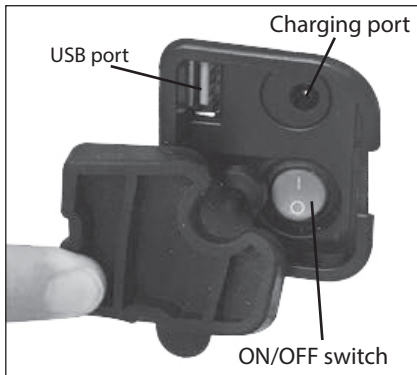

Fig.18

1. Security

1. You are supplied with 2 keys to secure your battery to your bike. It is advisable to separate the keys as they cannot be replaced if lost.
2. Release the Quick release mechanism and open the hinged frame, insert the key and unlock the battery enabling you to remove for security or to charge away from the bike. (Fig.16 and 17)
3. Once unlocked the battery is withdrawn from the frame to replace simply reverse the procedure.

2. Battery operation

1. Switching ON/OFF is by way of a switch on the front left-hand side, which lies under a rubber cover (Fig.18)
Remember to switch OFF when not in use as this may drain the battery
2. Pulling back the cover also reveals the battery charging port and USB charging port which can be used for devices such as mobile phones.

3. Battery Charger

1. NOTE: Only charge your battery with the Charger supplied with your e.life The charger is set to 220/240V. Never use 110v setting.
2. Avoid dropping the Charger as this may damage the sensitive electronics within the casing.
3. You can leave the battery charging, it will stop charging by itself when it has reached full charge, but it is not recommended to leave charging for any considerable time over what is required.



Fig.19

To fully charge your battery
takes approx. 2-3 hours

Charging your Battery

Your Lithium Battery arrives partially charged.

Your Battery can be charged on or off your bike.

1. Plug your charger into the mains, the LED light will illuminate GREEN
2. Connect the charger to the battery using the lead provided, the LED light on the charger will change to RED. This indicates it is charging.
3. Once Fully charged the LED light on the charger switches back to GREEN indicating the battery is fully charged, and then goes off.

Basic rules to follow when charging your battery

1. Do not cover charger with any material or substance that may restrict airflow to the charger. The charger needs to 'Breathe' to keep cool.
2. Charging your battery each time you use it no matter how far the trip, will prolong the life of the battery.
3. DO NOT leave the battery discharged for long periods.
4. Never open the charger or change settings on charger.

Maintenance of your e.bike



It is ok to oil the front and rear axles and chain . The Motor should not be lubricated.

General

1. Wipe your bike over with a dry cloth, or neutral detergent.
2. Use lubrication oil for metal parts. i.e. chain, axles.
3. Wipe down Plastics, paint coated parts with a quality cloth.
4. Increase the frequency of lubricating oil at wet or humid areas
(Recommend 30SAE lubricating oil)

Weekly Inspection

It is recommended that after this period you should inspect your bike as things will slacken off and need re-tightening.

3 Month Inspection

We recommend after 3 months you complete a full service on your bike to keep it in excellent working order. The simplest way is to take into your local bike shop.

When stored and not in use remove the battery and store in a cool, dry place, charging periodically as the battery will discharge over time of non use. Failure to do this will result in the battery falling into a dormant state rendering the battery unrepairable.

PLEASE NOTE:

If you do not feel that you can complete the maintenance of your bike, please take it to your local bicycle workshop where they will be able to assist you.

If unsure on any of these points, or you fail to correct the problem, please call the helpline who will be able to advise you.

Please call our
Technical help line:
(weekdays 9am-5pm)

01702208187
(standard call rate charge applies)

Simple Troubleshooting

Problem	Check	Action
Low Speed	battery power	Charge Battery
	Tyre pressure	Inflate tyre
	If tyre flat	Repair tyre
	Load	Do not overload
The Motor is not working Power indicator light does not come on	Every plug	Ensure every plug is connected Check the sensor is still in place on the on the bottom bracket Contact Helpline
Power indicator on battery is on, but the bike doesn't work.	Loose wiring or connection.	Check wiring and connections, check Sensor as above Contact Helpline.
Reduce battery performance.	Is the battery fully charged?	If NOT, charge fully.
Charger not giving full charge.	Check the light on charge remains RED during charging period?	If NOT, replace charger
Low Battery power	charger works correctly?	Replace Battery.
Brakes loose	Cable tension Worn blocks	Take to cycle shop for service.

Warranty



Subject to the following, Ideal World warrants that the goods will correspond with their specification at the time of purchase and will be free from defects in material and workmanship.

Ideal World offers a 2 year warranty on the frame from any problems relating to manufacturer workmanship or arising from material defects including breakages or cracking caused whilst riding (other than rider misuse).

Ideal World offers 12 months warranty on the battery and motor for any problems relating to manufacturers workmanship or arising from material defects. The warranty does not cover misuse or failure to follow the manufacturer's operational instructions correctly.

All other components are guaranteed for 1 year for problems related to manufacturer workmanship or arising from material defects with the exception of consumable components for example brake blocks, pads, grips, tyres and tubes.

Ideal World offers this warranty to the original purchaser of the product. This warranty is not transferable to a third party.

PLEASE NOTE:

Any figures quoted regarding battery performance or distances which can be obtained per single charge are based on standard test conditions. Diverse terrain and rider weight will of course produce varying results from those stated.

Replacement Batteries & Chargers

Replacement batteries and chargers are available to fit your bike and can be purchased separately from Ideal World.

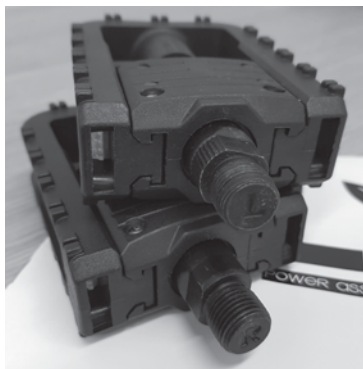
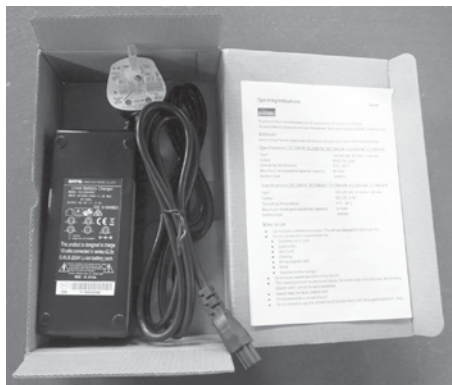

Should you ever need to remove or replace your pedals it is important to know that left-hand pedal screws in **ANTI-CLOCKWISE** and the right-hand pedal screws in **CLOCKWISE**. Pedals are normally stamped on the ends of the axle of the pedal as in the photo, L and R.

Nation service Centre

ELIFE have teamed up with



to offer all Ideal World customers a Nationwide Service for your e.bike. If you live in Scotland or Cornwall or anywhere in between and you want the best electric bike service then please contact us for more information.

Monday - Saturday 9am - 5pm.

Line 1. 02380 236 540

Line 2. 02380 224 344



IMPORTANT!

PLEASE REMEMBER THAT IT IS IMPORTANT TO KEEP THE CARTON YOUR BIKE ARRIVED IN , COURIERS CANNOT COLLECT YOUR BIKE WITHOUT A CARTON SHOULD YOU HAVE NEED TO RETURN IT TO US.

Please call our
Technical help line:
(weekdays 9am-5pm)

01702208187

(standard call rate charge applies)



POWER ASSISTED BICYCLES

Distributed in the UK by

Ideal World

Ideal Home House,
Newark Road,
Peterborough,
PE1 5WG

There are video tutorials online or on Ideal World's website designed to assist you if you need help.

Please call our
Technical help line:
(weekdays 9am-5pm)

01702208187

(standard call rate charge applies)